

**EN**

## OPERATOR'S MANUAL



# OZ BUILDER'S HOIST MOUNTING ARM BRACKET 1000 lbs. W.L.L

**100% made in the USA.**

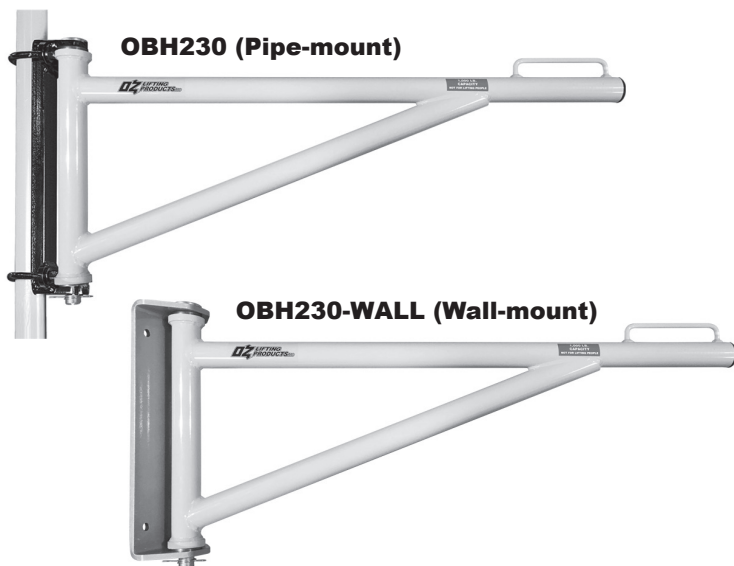

**(For use with OZ Builder's Hoist OBH500 & OBH1000)**

Serial # \_\_\_\_\_

Purchase Date: \_\_\_\_\_



P.O. Box 845, Winona, MN 55987  
Phone (800) 749-1064  
(507) 474-6250  
Tech Support (507) 457-3346  
Fax (507) 452-5217  
sales@ozliftingproducts.com  
[www.ozliftingproducts.com](http://www.ozliftingproducts.com)

# Table of Contents

**Pg.2** ..... **Product Features**

**Pg.3** ..... **Warranty**

**Pg.4** ..... **Important Information and Precautions / Warnings**

**Pg.5** ..... **Technical Information/ Pre-Installation**

**Pg.6** ..... **Operation**

**Pg.7** ..... **Operation / Maintenance**

## Product Features

- Long Lasting Powder Coated Finish
- Portable / Light Weight
- Solid Mounting Bracket
- Quick Mount
- Made in USA



# ONE YEAR WARRANTY

OZ Lifting Products LLC® guarantees this product to be free of defects in materials and workmanship for one year from the date of shipment.

This warranty does not apply to products that show signs of misuse, overloading, alteration, improper maintenance or negligence. The normal wear and tear of moving parts is excluded from the warranty. Moving parts are defined as brake discs, wire rope and other wear components that are subject to use conditions. This warranty does not cover any costs related to removal of this product, lost time, or any other incidental or consequential damages/costs resulting from the claimed defects.

If this product fails during the first year of operating due to defective materials or workmanship, it will be repaired or replaced at the discretion of OZ Lifting Products LLC®. Any product subject to a warranty claim must be returned, prepaid, to an authorized OZ Lifting Products LLC® warranty depot along with proof of purchase. Upon repair, the product will be returned to the customer free of charge. If no defect is found, the customer will be responsible for return shipping costs. The product's warranty will be effective for the remainder of the original warranty period (one year from shipment date).

It is the operator's responsibility to ensure that the product is used in accordance with all applicable local codes, regulations, and safety standards. OZ Lifting Products, LLC assumes no liability for any damages or injuries resulting from the improper use of the product.

OZ Lifting Products LLC® will not be held liable for the following arising from the use of this product: injuries to persons or property, death, incidental, consequential, or contingent damages, whether negligent or deliberate. It is the sole responsibility of the owner to install and operate the product properly and safely.

This is OZ Lifting Products LLC®'s only written warranty. This warranty is in lieu of all other warranties implied by law such as merchantability and fitness. The sale of products from OZ Lifting Products LLC® under any other warranty or guarantee, expressed or implied, is not authorized.

NOTE: OZ Lifting Products LLC® has the right to alter the design of or discontinue the production of any product without prior notice.

**For more information please contact:**



P.O. Box 845, Winona, MN 55987

Phone (800) 749-1064

(507) 474-6250

Tech Support (507) 457-3346

Fax (507) 452-5217

sales@ozliftingproducts.com

[www.ozliftingproducts.com](http://www.ozliftingproducts.com)

# Important Information and Precautions

The information in this manual should be used only for the **OBH MOUNTING ARM BRACKET**. This manual contains general instructions dealing with the normal installation, operation, and maintenance of the product described herein. The information provided should not be expected to prepare the user for all possible circumstances.

This product should not be installed, operated, or maintained by any person who has not read all the contents of these instructions. Failure to read and comply with these instructions, warnings, or limitations noted might result in bodily injury, death, or property damage. Contact the distributor for further explanation if information is not fully understood.

It is the responsibility of the owner/user to install, test, maintain, and operate these products in accordance with OSHA regulations, other federal, state, local regulations, and ANSI standards.

Only trained and qualified personnel shall operate and maintain this equipment.

## Maintain Records

Schedule and maintain records of regular inspection and maintenance of the product in compliance with ANSI standards.

Record your **OBH MOUNTING ARM BRACKET's** serial number on the front cover of this manual to allow for easier referencing.

## Precautions

Do not use the **OBH MOUNTING ARM BRACKET** in conjunction with other equipment unless the system designer, manufacturer, installer, or user has put the necessary safety devices in place. Modifications to upgrade or alter these products should only be authorized by the original manufacturer.

The **OBH MOUNTING ARM BRACKET** should be used for holding loads only within their load ratings.

## Warnings

**Failure to read and comply with the following warnings may result in a hazardous situation that could lead to death, serious injury, or property damage. Be sure to properly install, operate, and maintain the OBH MOUNTING ARM BRACKET so that it does not come off the beam.**

**Do Not** lift more than the designated load range.

**Do Not** lift people or lift loads over people.

**Do Not** operate a damaged or malfunctioning product.

**Do Not** remove, deface, or cover warning labels.

**Do Not** operate until personnel are warned and cleared from the area.

**Do Not** use if load is not suspended vertically.

**Do Not** use the OBH MOUNTING ARM BRACKET without locking firmly in place.

**Do Not** use the OBH MOUNTING ARM BRACKET as welding ground.

**Do Not** use the OBH MOUNTING ARM BRACKET for a buffer or grab.

**Do Not** weld on the lifted load.

**Do Not** use the OBH MOUNTING ARM BRACKET in corrosive environments.

**Do Not** use connections between the OBH MOUNTING ARM BRACKET and OZ BUILDER'S HOIST.

**Do Not** allow the load to swing.



# Technical Information

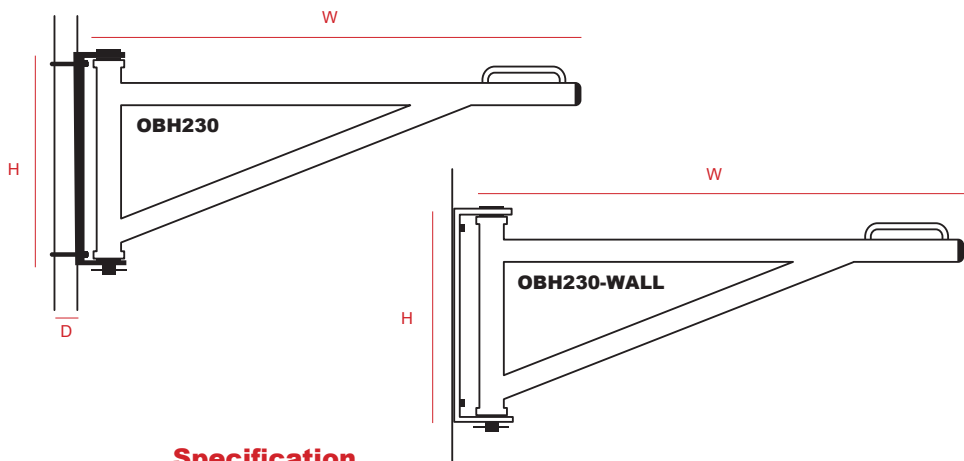

## Specification

	OBH230	OBH230-WALL
Width (W)	40 1/2 inches	40 1/2 inches
Height (H)	17 3/4 inches	17 3/4 inches
Mounting Pipe (D)	2 inches	n/a
Capacity	1000 pounds	1000 pounds
Net Weight	26 pounds	31 pounds

# Pre-Installation

Check for damage during shipment. Do not install or use a damaged product. Ensure that the spindle is functioning properly. Be sure to maintain records of all accompanying product information.

Contact your OZ Lifting Products LLC® dealer if there are any problems.

## Before initial operation:

Read and comply with all instructions and warnings furnished with or attached to the product as applicable.

# Operation

## Warnings & Precautions

**OBH MOUNTING ARM BRACKET** operators should read and fully comprehend this entire manual and all warnings on the clamp before beginning clamp operation. If this manual is not read and followed completely injuries may occur.

## All Operators MUST:

- Be trained in proper swing arm operation and in dealing with potential malfunctions.
- Abstain from use of alcohol, medications, or drugs while operating.
- Avoid operation while tired or distracted.
- Avoid operation if they have a history of seizures or other medical issues that may interfere with operation.
- Have proper coordination and vision.

**NOTE:** Prior to operation, ensure **OBH MOUNTING ARM BRACKET** is in proper working condition and maintenance records are up to date.

The **OBH MOUNTING ARM BRACKET** is pre-assembled (with the exception of the u-bolts for mounting to scaffolding for product **OBH230**). Prior to installation ensure that unit received is complete (refer to picture below), should one find missing hardware please contact **OZ Lifting Products** immediately.

## OBH230-Pipe Operation

It is recommended that two (2) personnel are utilized for installation onto the scaffolding or mounting point; however, by disassembling the bracket from the arm it is possible for one (1) individual to mount the **OBH230**. Great care is required not to lose any of the associated hardware. Please note the location of hardware prior to disassembly, if required one can reference the picture below during the reassembly process.

There should be one (1) **OBH230** Swing Arm, one (1) mounting bracket, one (1) hinge pin, two (2) washers located between the swing arm and mounting bracket with one (1) at each end and one (1) locking pin. Additionally, there is one (1) package labeled "U-bolts" with two (2) U-bolts each with two (2) nuts and two (2) washers as shown below. Please note only one U-bolt is shown below.

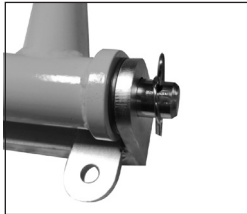

\*Please note – mounting bracket purchased may appear different from one pictured.

The recommended size pipe that the **OBH230** can be mounted to is 2". Mounting to the wrong size pipe is not recommended and may damage mounting bracket.

- 1) Remove nuts and washers from U-bolts taking care not to lose any hardware.
- 2) Place arm assembly or bracket in desired mounting location. Insert U-bolt into upper set of ears on mounting bracket and place washer first then nut and finger tighten. Repeat with second U-bolt in lower set of ears on mounting bracket. Utilizing a 7/8 socket or wratching wrench tighten nuts to no more than 29 foot/pounds.
- 3) Periodically check the tightness of the bolts and re-tighten as required.

**PLEASE CONTACT OZ LIFTING PRODUCTS FOR REPLACEMENT HARDWARE**

### NOTE:

U-bolts must be tightened and torqued using a cross pattern sequence.

Tighten #1 then #4 partial torque then partial torque #2 and #3.

Using the same sequence fully torque U-bolt nuts.

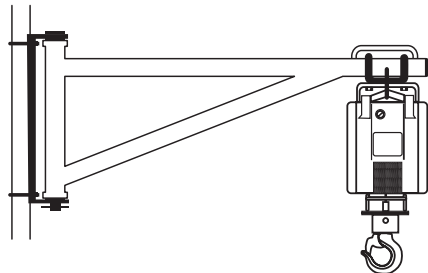
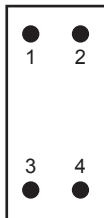

## OBH230-WALL Operation

It is recommended that two (2) personnel are utilized for installation onto the mounting point; however, by disassembling the bracket from the arm it is possible for one (1) individual to mount the **OBH230-WALL**. Great care is required not to lose any of the associated hardware. Please note the location of hardware prior to disassembly, if required one can reference the picture below during the reassembly process.

There should be one (1) **OBH230-WALL** swing arm, one (1) mounting bracket, one (1) hinge pin, two (2) washers located between the swing arm and mounting bracket with one (1) at each end and one (1) locking pin.

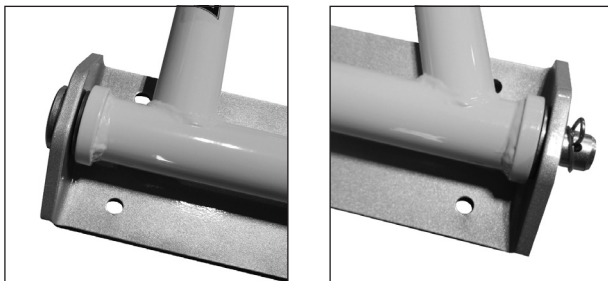

\*Please note – mounting bracket purchased may appear different from one pictured.

1) Select a suitable mounting point on a flat vertical surface. It is the customers responsibility to ensure the mounting point surface and mounting hardware is appropriate for use.

2) Use provided drill template for bolt pattern.

**PLEASE CONTACT OZ LIFTING PRODUCTS FOR REPLACEMENT HARDWARE**

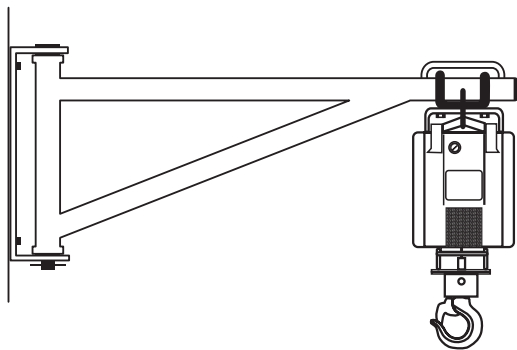

## Maintenance

Operators should visually inspect the **OBH MOUNTING ARM BRACKET** on a regular basis. Observe for wear, damage, cuts, cracks, or corrosion. Verify that the spindle is freely moving. If any problems are observed, the **OBH MOUNTING ARM BRACKET** should be placed out of service until it can be repaired. Use only OZ Lifting Products LLC® for replacement parts.

The **OBH MOUNTING ARM BRACKET** should be taken annually to an authorized repair center for professional inspection.

Following repair, test the **OBH MOUNTING ARM BRACKET** with a load that is 1.25 times the rated load to re-certify the product.









Scan to access translated versions  
of this manual on our website.  
Escanee para acceder a las versiones  
traducidas de este manual en nuestro sitio web.  
Scannez pour accéder aux versions  
traduites de ce manuel sur notre site Web.



P.O. Box 845, Winona, MN 55987  
Phone (800) 749-1064  
(507) 474-6250  
Tech Support (507) 457-3346  
Fax (507) 452-5217  
sales@ozliftingproducts.com  
[www.ozliftingproducts.com](http://www.ozliftingproducts.com)

Rev. 06/12/24